

FORM B – BUILDING

Assessor's Number USGS Quad Area(s) Form Number

MASSACHUSETTS HISTORICAL COMMISSION
MASSACHUSETTS ARCHIVES BUILDING
220 MORRISSEY BOULEVARD
BOSTON, MASSACHUSETTS 02125

15-21	New Bedford South		DAR.23
-------	-------------------------	--	--------

Photograph



Town: Dartmouth

Place:

Address: 322 Smith Neck Road

Historic Name: L. Crapo (1856)

Uses: Present: single family home

Original: same

Date of Construction: ca. 1790

Source: historic mapping

Style/Form: Transitional Georgian/Federal in 1983 survey

Architect/Builder:

Exterior Material:

Foundation: stone

Wall/Trim: shingles

Roof: asphalt shingle

Outbuildings/Secondary Structures: large 19th c. barn

Major Alterations (with dates): roofline altered ca. 1900

Condition: Good

Moved: no | | yes | | **Date**

Acreage: 2.292 Acres

Setting: rural

Topographic or Assessor's Map

see continuation sheet

Recorded by: Richard M. Casella / Wm. Coutu

Organization: Historic Documentation Co., Inc.

Date: 2008

INVENTORY FORM B CONTINUATION SHEET

[DARTMOUTH] [322 Smith Neck Road]

MASSACHUSETTS HISTORICAL COMMISSION
220 MORRISSEY BOULEVARD, BOSTON, MASSACHUSETTS 02125

Area(s) Form No.

DAR.23

___ Recommended for listing in the National Register of Historic Places.
If checked, you must attach a completed National Register Criteria Statement form.

ARCHITECTURAL DESCRIPTION:

This transitional Georgian/Federal dwelling is a five bay, 2 story structure with large corbelled brick chimneystacks at either end. The windows are 12/12 sash and later period shutters have been added sporadically to the windows. The entrance is surrounded by two paneled pilasters and surmounted by an extremely heavy architrave and cornice cap. There is a slight transom located directly underneath the architrave. The foundation is stone. The eaves have been altered. With the addition of an extended overhang supported by heavy bracketing. It is not readily ascertainable if the alterations have been extended to the roofline itself. [Note: Preceding description transcribed from 1983 survey form]

HISTORICAL INFORMATION:

1856 Map: House shown with name "L. Crapo"

1871 Map: House shown with name "I.L. Crapo"

1895 Map: House shown with name "Isaac Crapo"

Tax Card, 1st Entry: 1903, H.G. Dannie, Book 236 Page 555

BIBLIOGRAPHY and/or REFERENCES

Walling, Henry F., *Map of the Town of Dartmouth, Bristol County, Mass.* 1856.

Beers, F. W., *Atlas of Bristol County, Massachusetts.* New York: F.W. Beers & Co., 1871

Walling, Henry F., *Map of Bristol County, Massachusetts.* 1895.

Town of Dartmouth, Massachusetts, Tax Assessor's Record Cards.

INVENTORY FORM B CONTINUATION SHEET

[DARTMOUTH] [322 Smith Neck Road]

MASSACHUSETTS HISTORICAL COMMISSION
220 MORRISSEY BOULEVARD, BOSTON, MASSACHUSETTS 02125

Area(s) Form No.

DAR.23

LOCATION MAPPING

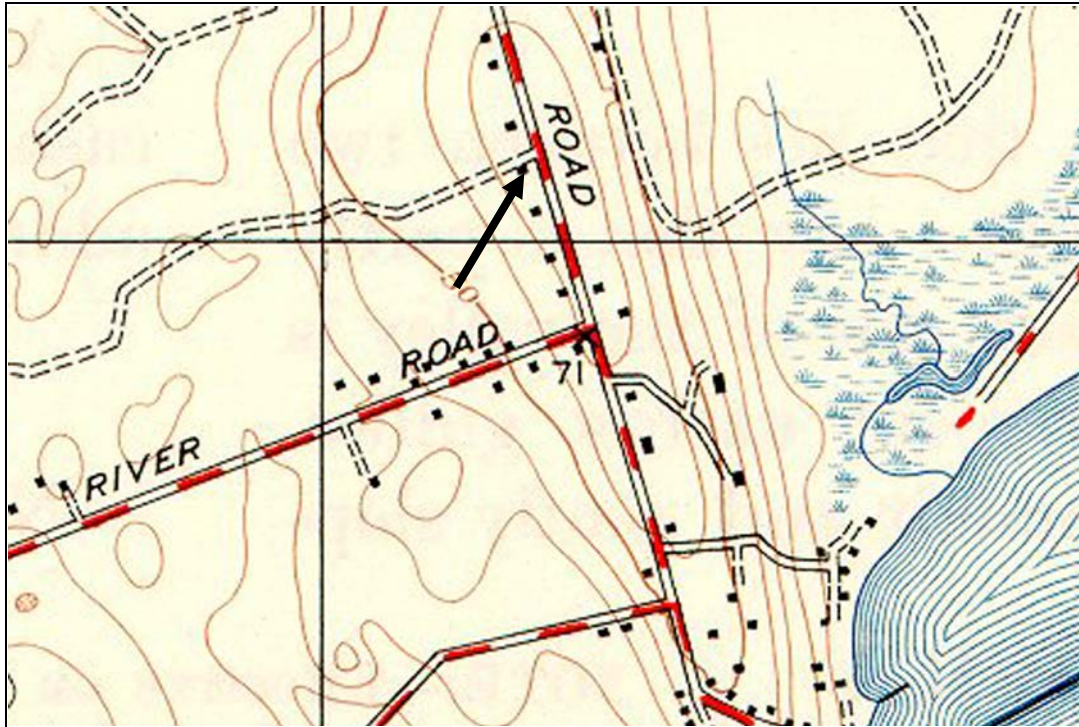

USGS Topographic Map New Bedford South Quadrangle 1941, Revised 1948

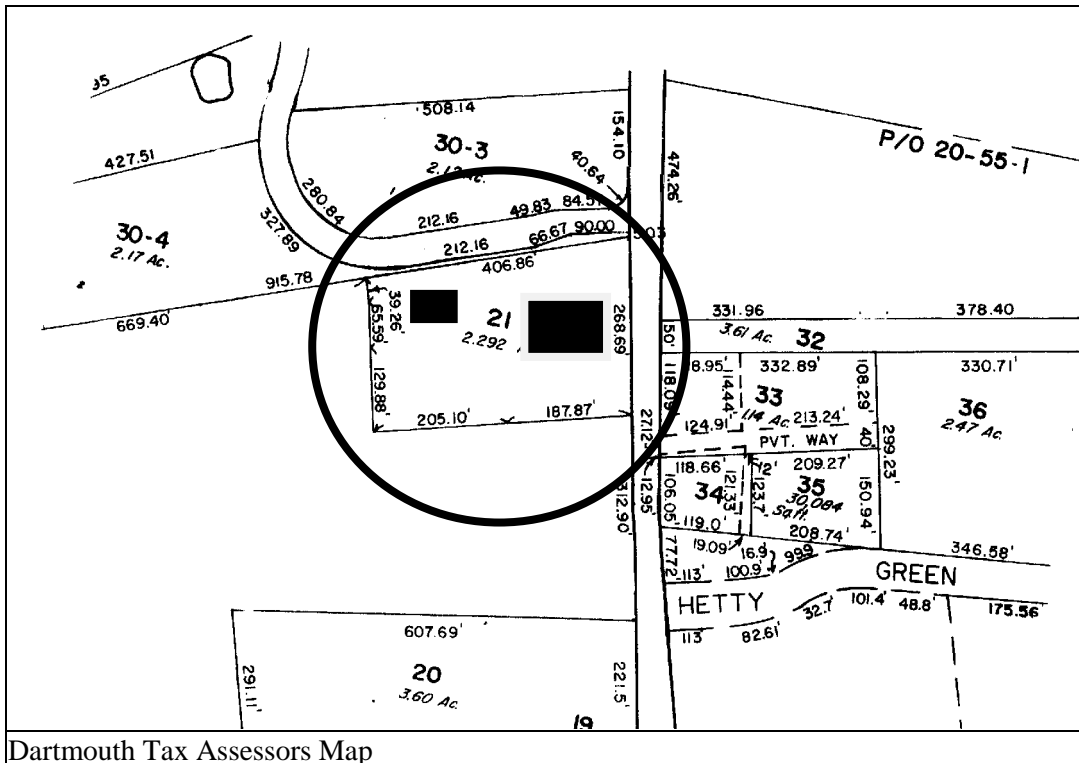

Dartmouth Tax Assessors Map

INVENTORY FORM B CONTINUATION SHEET

[DARTMOUTH] [322 Smith Neck Road]

MASSACHUSETTS HISTORICAL COMMISSION
220 MORRISSEY BOULEVARD, BOSTON, MASSACHUSETTS 02125

Area(s) Form No.

DAR.23

ARCHIVAL PHOTOGRAPHIC PRINT(S) ATTACHED:



INVENTORY FORM B CONTINUATION SHEET

[DARTMOUTH] [322 Smith Neck Road]

MASSACHUSETTS HISTORICAL COMMISSION
220 MORRISSEY BOULEVARD, BOSTON, MASSACHUSETTS 02125

Area(s) Form No.

DAR.23

ARCHIVAL PHOTOGRAPHIC PRINT(S) ATTACHED:

