

# FORM B – BUILDING

Assessor's Number    USGS Quad    Area(s)    Form Number

MASSACHUSETTS HISTORICAL COMMISSION  
MASSACHUSETTS ARCHIVES BUILDING  
220 MORRISSEY BOULEVARD  
BOSTON, MASSACHUSETTS 02125

178-98	New Bedford North		DAR.491
--------	-------------------------	--	---------

## Photograph



**Town:** Dartmouth

**Place:**

**Address:** 82 Bryant Street

**Historic Name:**

**Uses: Present:** single family home

**Original:** same

**Date of Construction:** ca.1781 ?

**Source:** Tax Database

**Style/Form:** no style

**Architect/Builder:**

**Exterior Material:**

Foundation: stone

Wall/Trim: shingles

Roof: asphalt shingle

**Outbuildings/Secondary Structures:** No

**Major Alterations** *(with dates):*

yes, see description

**Condition:** Fair

**Moved:** no | x | yes | | **Date**

**Acreage:** 41,412 sq. ft.

**Setting:** residential

## Topographic or Assessor's Map

see continuation sheet

**Recorded by:** Richard M. Casella

**Organization:** Historic Documentation Co., Inc.

**Date:** 2008

**INVENTORY FORM B CONTINUATION SHEET**

[DARTMOUTH] [82 Bryant Street]

MASSACHUSETTS HISTORICAL COMMISSION  
220 MORRISSEY BOULEVARD, BOSTON, MASSACHUSETTS 02125

Area(s) Form No.

DAR.491

\_\_\_ Recommended for listing in the National Register of Historic Places.  
*If checked, you must attach a completed National Register Criteria Statement form.*

**ARCHITECTURAL DESCRIPTION:**

This is a 1-story rectangular plan low pitch gable-on-hip roof house structure partly on a parged stone foundation. A small second-entrance wing juts from the right side of the house near the rear. Tax records state this house was built in 1781. It is possible that a small Cape Cod structure is buried under the complete makeover of the house that probably occurred in the early 20<sup>th</sup> century. The front façade appears to originally have been a porch, later enclosed. The porch enclosure may have been done at the same time as the rear addition as the 3 paired 2/1 windows across the front of the façade & the single 2/1 window located on the left side of the enclosure appear to be identical to those 2/1 windows located in the rear addition. The windows located on both sides of the structure are larger and capped with a distinctive trim board. These would appear to be original to the structure. There appears to be a parged brick chimney located on the middle right slope of the main block. The entrances are located on the right side of the structure. The structure is shingled and rests on parged stone with the exception of the enclosed front porch and the wing that are probably on posts enclosed with boards.

**HISTORICAL INFORMATION:****1856 Map:** House not shown**1871 Map:** House not shown**1895 Map:** House shown with name Wm. C. Jones?**Tax Card, 1<sup>st</sup> Entry:** 4/16/1913, Rosina Laque, Book 388 Page 05**BIBLIOGRAPHY and/or REFERENCES**Walling, Henry F., *Map of the Town of Dartmouth, Bristol County, Mass.* 1856.Beers, F. W., *Atlas of Bristol County, Massachusetts.* New York: F.W. Beers & Co., 1871Walling, Henry F., *Map of Bristol County, Massachusetts.* 1895.

Town of Dartmouth, Massachusetts, Tax Assessor's Record Cards.

# INVENTORY FORM B CONTINUATION SHEET

[DARTMOUTH] [82 Bryant Street]

MASSACHUSETTS HISTORICAL COMMISSION  
220 MORRISSEY BOULEVARD, BOSTON, MASSACHUSETTS 02125

Area(s) Form No.

DAR.491

## LOCATION MAPPING

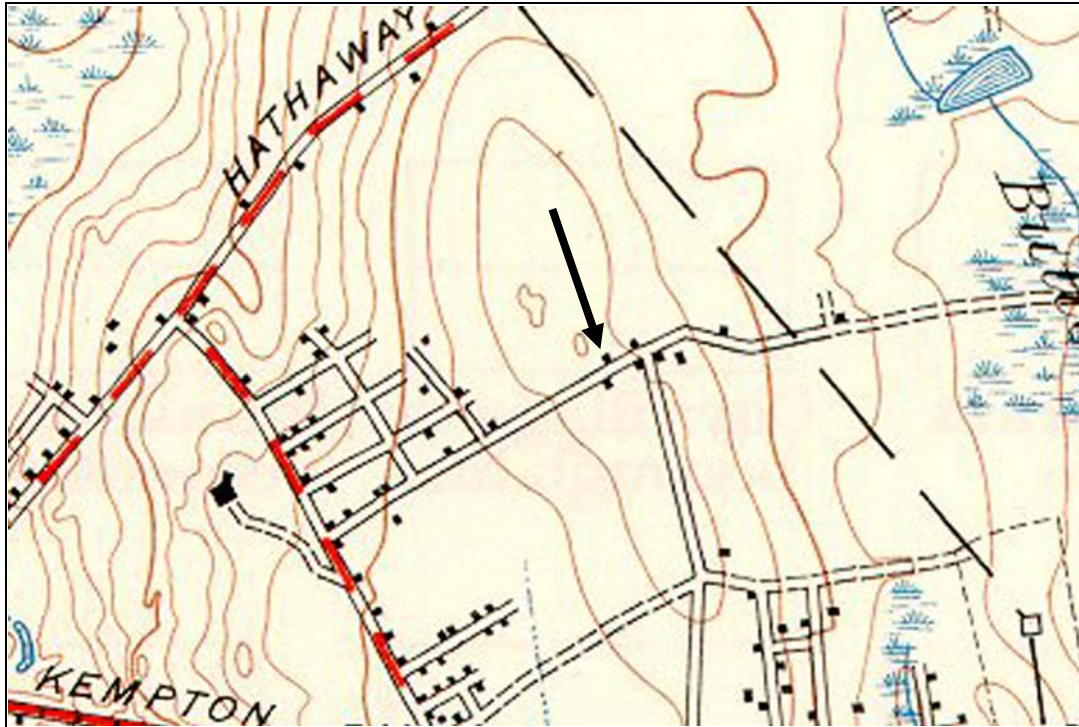

USGS Topographic Map New Bedford North Quadrangle 1941, Revised 1948

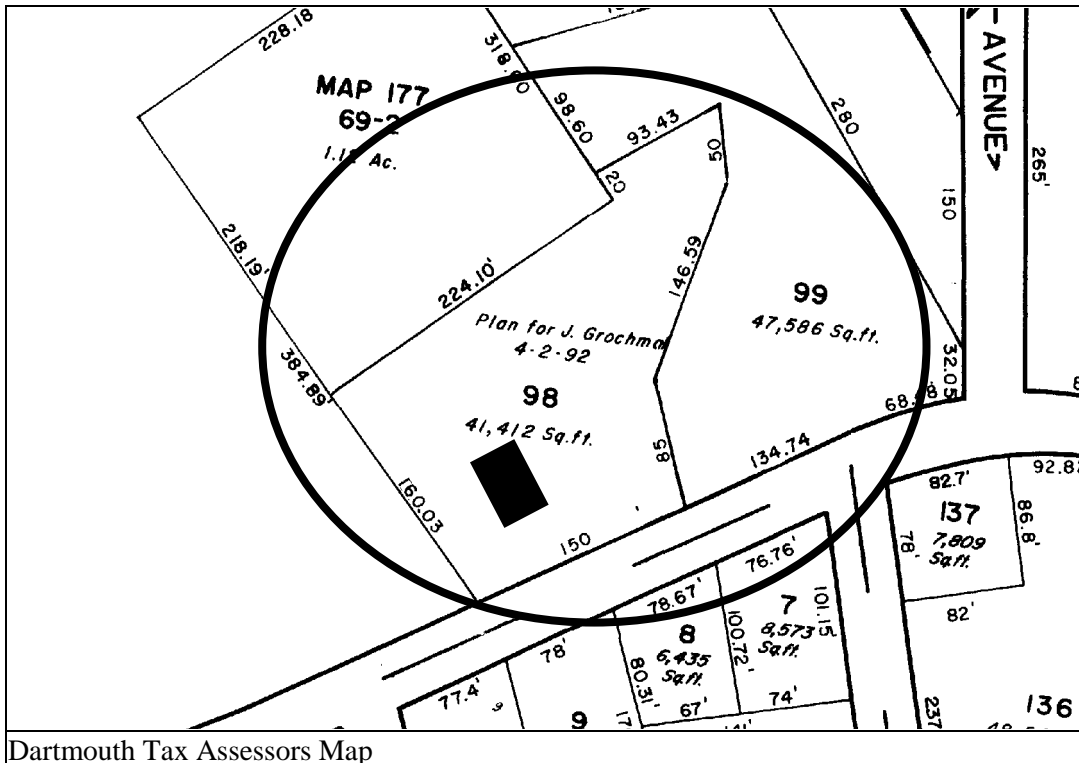

Dartmouth Tax Assessors Map



**INVENTORY FORM B CONTINUATION SHEET**

[DARTMOUTH] [82 Bryant Street]

MASSACHUSETTS HISTORICAL COMMISSION  
220 MORRISSEY BOULEVARD, BOSTON, MASSACHUSETTS 02125

Area(s) Form No.

DAR.491

**ARCHIVAL PHOTOGRAPHIC PRINT(S) ATTACHED:**



No.



No.