

FORM B – BUILDING

Assessor's Number USGS Quad Area(s) Form Number

MASSACHUSETTS HISTORICAL COMMISSION
MASSACHUSETTS ARCHIVES BUILDING
220 MORRISSEY BOULEVARD
BOSTON, MASSACHUSETTS 02125

127-57	New Bedford South		DAR.520
--------	-------------------	--	---------

Town: Dartmouth

Place:

Photograph



Address: 666 Elm Street

Historic Name: A. Gifford (1856)

Uses: Present: single family home

Original: same

Date of Construction: ca. 1771

Source: Tax assessor, stylistic, plaque on house

Style/Form: Colonial Cape Cod

Architect/Builder:

Exterior Material:

Foundation: stone

Wall/Trim: shingles

Roof: asphalt shingle

Outbuildings/Secondary Structures: carriage barn

Major Alterations (*with dates*):

Condition: Good

Moved: no | x | yes | | **Date**

Acreage: 3.99

Setting: residential village

Topographic or Assessor's Map

see continuation sheet

Recorded by: Richard M. Casella

Organization: Historic Documentation Co., Inc.

Date: 2008

INVENTORY FORM B CONTINUATION SHEET

[DARTMOUTH] [666 Elm Street]

MASSACHUSETTS HISTORICAL COMMISSION
220 MORRISSEY BOULEVARD, BOSTON, MASSACHUSETTS 02125

Area(s) Form No.

DAR.520

Recommended for listing in the National Register of Historic Places.
If checked, you must attach a completed National Register Criteria Statement form.

ARCHITECTURAL DESCRIPTION:

A 1-1/2 story half Cape Cod house, 3 bays wide, with a 2-story rear gable ell. The front entrance door is wood, four lights over four panels with a wood storm door. The door and windows are all trimmed with simple narrow flat casings and a capped lintel that appear to be a replacement. Windows are wood 2/1 with aluminum storms. In the right gable there are 2 full-size window flanked by 2 small square fixed sash windows. A large brick chimney is located on the ridge above the entrance. The main block rests on a stone foundation, but the rear ell is on a rusticated concrete block foundation, probably early 20th century. The roof pitch of the ell is lower than the main block and significant door and window changes have been made recently on the left side. On the right side are a door, window and exterior brick chimney. The entire structure is shingled. There is a 1-1/2 story front gable carriage barn with a 1-story rear shed addition located behind the house. The barn has 6/6 wooden sash windows, a wagon door, and hay door in the gable.

HISTORICAL INFORMATION:

1856 Map: House shown with name "A. Gifford"

1871 Map: House not shown

1895 Map: House shown with no name

Tax Card, 1st Entry: 1889, Joseph R. Funaus, Book 134 Page 503

BIBLIOGRAPHY and/or REFERENCES

Walling, Henry F., *Map of the Town of Dartmouth, Bristol County, Mass.* 1856.

Beers, F. W., *Atlas of Bristol County, Massachusetts.* New York: F.W. Beers & Co., 1871

Walling, Henry F., *Map of Bristol County, Massachusetts.* 1895.

Town of Dartmouth, Massachusetts, Tax Assessor's Record Cards.

INVENTORY FORM B CONTINUATION SHEET

[DARTMOUTH] [666 Elm Street]

MASSACHUSETTS HISTORICAL COMMISSION
220 MORRISSEY BOULEVARD, BOSTON, MASSACHUSETTS 02125

Area(s) Form No.

DAR.520

LOCATION MAPPING

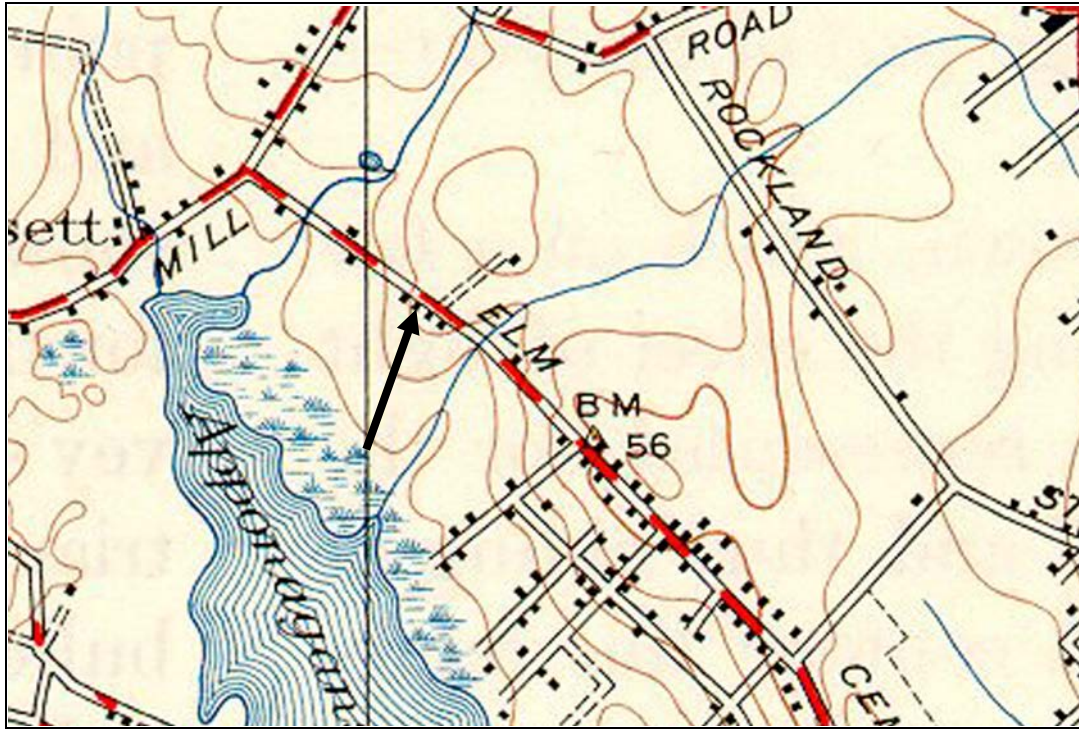

USGS Topographic Map New Bedford South Quadrangle 1941, Revised 1948

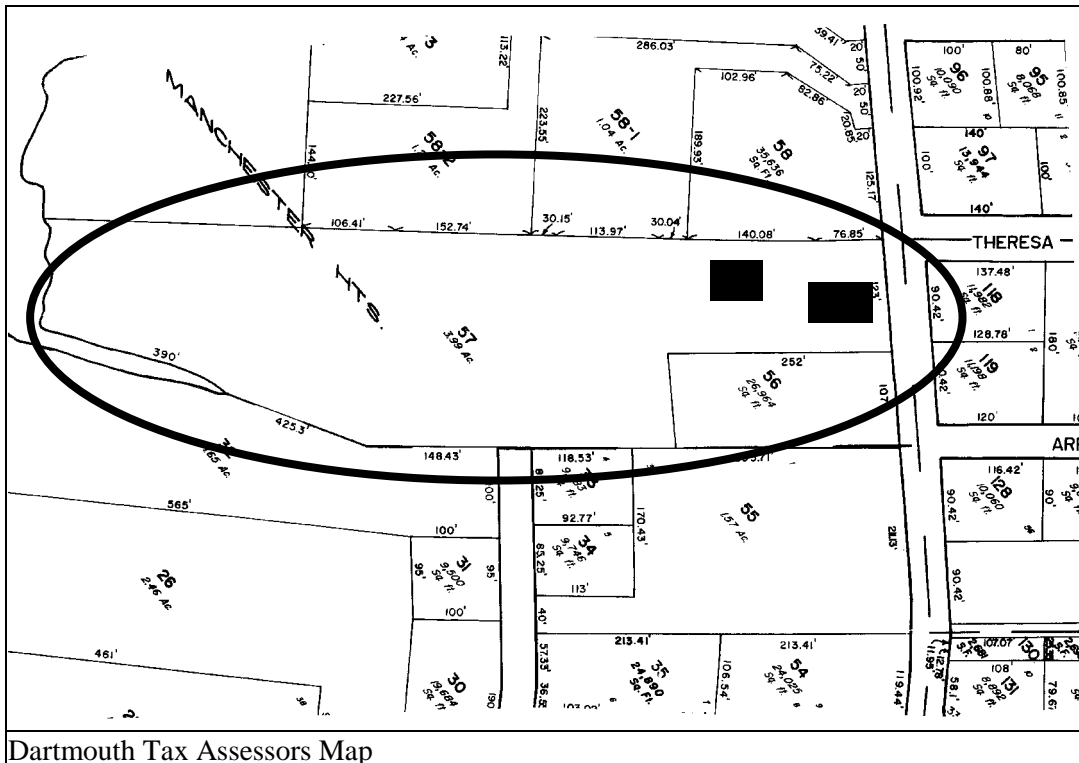

Dartmouth Tax Assessors Map

INVENTORY FORM B CONTINUATION SHEET

[DARTMOUTH] [666 Elm Street]

MASSACHUSETTS HISTORICAL COMMISSION
220 MORRISSEY BOULEVARD, BOSTON, MASSACHUSETTS 02125

Area(s) Form No.

DAR.520

ARCHIVAL PHOTOGRAPHIC PRINT(S) ATTACHED:



No.



No.