

FORM B – BUILDING

Assessor's Number USGS Quad Area(s) Form Number

MASSACHUSETTS HISTORICAL COMMISSION
MASSACHUSETTS ARCHIVES BUILDING
220 MORRISSEY BOULEVARD
BOSTON, MASSACHUSETTS 02125

127-55	New Bedford South		DAR.16
--------	-------------------------	--	--------

Town: Dartmouth

Place:

Address: 658 Elm Street

Historic Name: C.H. Gifford (1856)

Uses: Present: single family home

Original: same

Date of Construction: ca. 1750 (1780 in Tax Database)

Source: historic mapping

Style/Form: Georgian

Architect/Builder:

Exterior Material:

Foundation: stone

Wall/Trim: clapboards

Roof: asphalt shingle

Outbuildings/Secondary Structures: Large barn

Major Alterations (*with dates*): enclosed porch off rear ell, ca. 2000

Condition: Good

Moved: no | X | yes | | **Date**

Acreage: 1.57 Acres

Setting: residential

Photograph



Topographic or Assessor's Map

see continuation sheet

Recorded by: Richard M. Casella/ Wm. Coutu
Organization: Historic Documentation Co., Inc.
Date: 2008

INVENTORY FORM B CONTINUATION SHEET

[DARTMOUTH] [658 Elm Street]

MASSACHUSETTS HISTORICAL COMMISSION
220 MORRISSEY BOULEVARD, BOSTON, MASSACHUSETTS 02125

Area(s) Form No.

DAR.16

___ Recommended for listing in the National Register of Historic Places.
If checked, you must attach a completed National Register Criteria Statement form.

ARCHITECTURAL DESCRIPTION:

This Georgian dwelling is faced with wood clapboards and contains four bays and 2 ½ stories. The 6/6 sash windows are most probably not original. The door and surrounding detail is probably a replacement also being of the Greek Revival style. This surround contains two paneled pilasters, a heavy architrave with a heavy cornice cap. The windows are surmounted by splayed lintels. At the center of the ridgeline is a large brick chimneystack. The Georgian dwelling is a typical example of pr-revolutionary war architecture found in the Padanaram Village of Dartmouth of which several survive. [Note: Preceding description transcribed from 1983 survey form]

HISTORICAL INFORMATION:

1856 Map: House shown with name "C. H. Gifford"

1871 Map: Map information inconclusive

1895 Map: House shown with name "Jno. Sherman"

Tax Card, 1st Entry: 8/15/1855, Herbert Wing, Book 29 Page 142

BIBLIOGRAPHY and/or REFERENCES

Walling, Henry F., *Map of the Town of Dartmouth, Bristol County, Mass.* 1856.

Beers, F. W., *Atlas of Bristol County, Massachusetts.* New York: F.W. Beers & Co., 1871

Walling, Henry F., *Map of Bristol County, Massachusetts.* 1895.

Town of Dartmouth, Massachusetts, Tax Assessor's Record Cards.

INVENTORY FORM B CONTINUATION SHEET

[DARTMOUTH] [658 Elm Street]

MASSACHUSETTS HISTORICAL COMMISSION
220 MORRISSEY BOULEVARD, BOSTON, MASSACHUSETTS 02125

Area(s) Form No.

DAR.16

LOCATION MAPPING

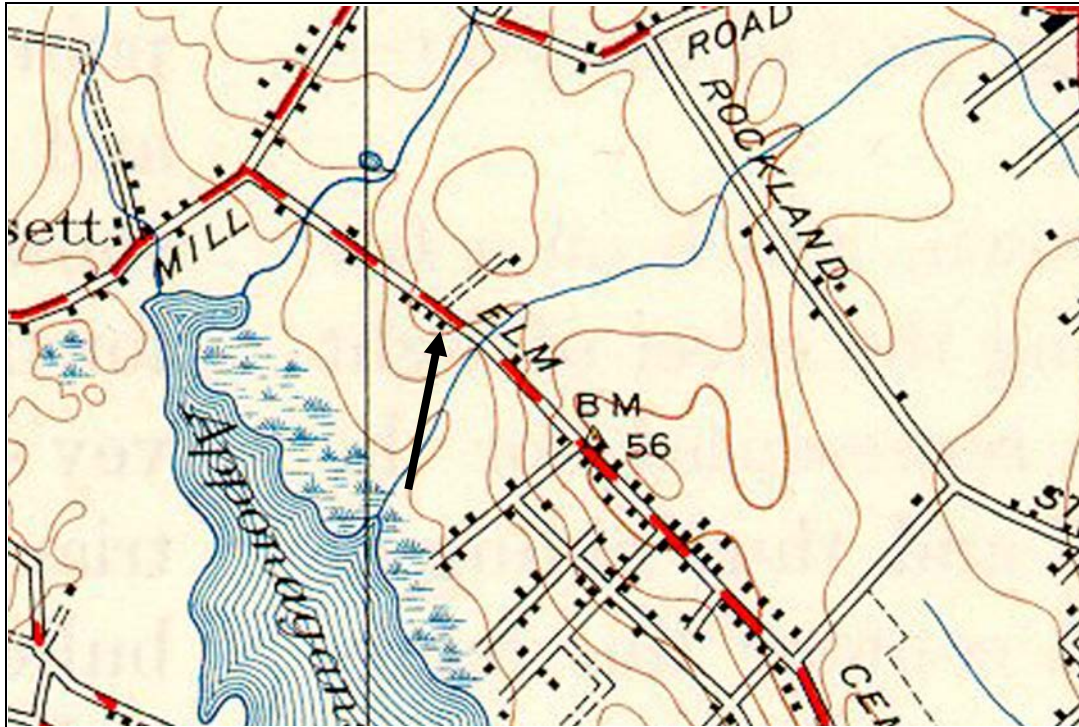

USGS Topographic Map New Bedford South Quadrangle 1941, Revised 1948

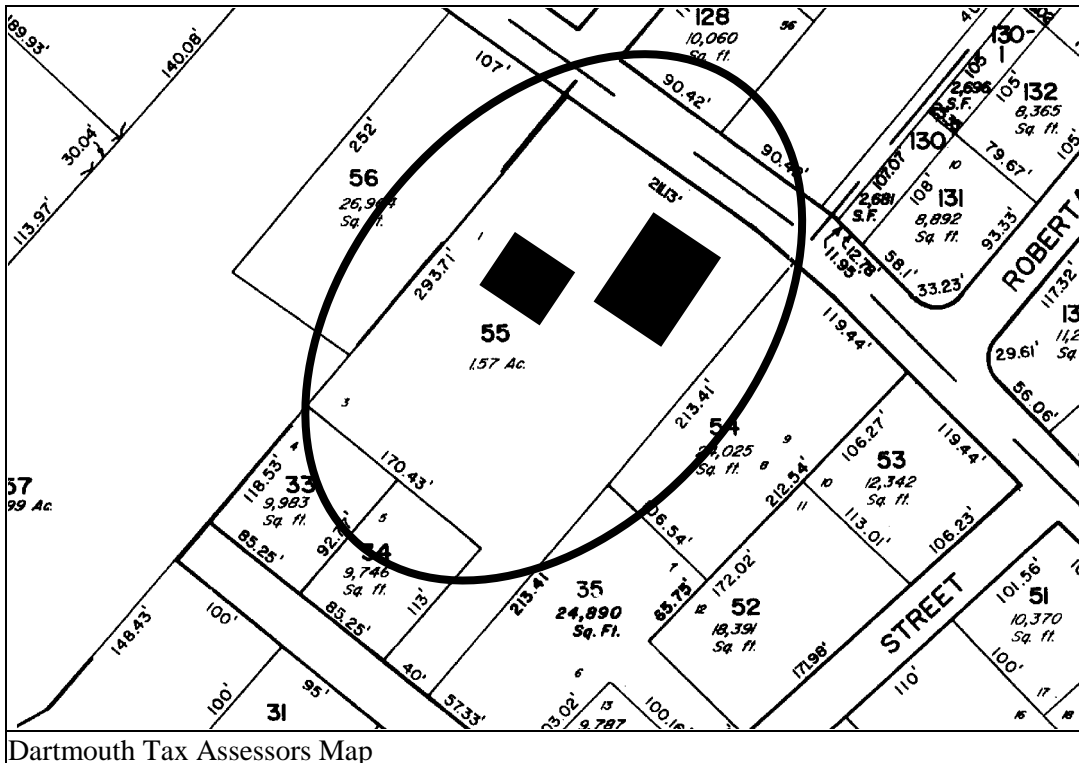

Dartmouth Tax Assessors Map

INVENTORY FORM B CONTINUATION SHEET

[DARTMOUTH] [658 Elm Street]

MASSACHUSETTS HISTORICAL COMMISSION
220 MORRISSEY BOULEVARD, BOSTON, MASSACHUSETTS 02125

Area(s) Form No.

	DAR.16
--	--------

ARCHIVAL PHOTOGRAPHIC PRINT(S) ATTACHED:



INVENTORY FORM B CONTINUATION SHEET

[DARTMOUTH] [658 Elm Street]

MASSACHUSETTS HISTORICAL COMMISSION
220 MORRISSEY BOULEVARD, BOSTON, MASSACHUSETTS 02125

Area(s) Form No.

	DAR.16
--	--------

ARCHIVAL PHOTOGRAPHIC PRINT(S) ATTACHED:

