

FORM B – BUILDING

MASSACHUSETTS HISTORICAL COMMISSION
MASSACHUSETTS ARCHIVES BUILDING
220 MORRISSEY BOULEVARD
BOSTON, MASSACHUSETTS 02125

Assessor's Number USGS Quad Area(s) Form Number

122-68	New Bedford South		DAR.111
--------	-------------------------	--	---------

Photograph



Topographic or Assessor's Map

see continuation sheet

Town: Dartmouth

Place:

Address: 557 Elm Street

Historic Name: C.S. Gifford (1856)

Uses: Present: single family home

Original: same

Date of Construction: 1830 in Tax Database

Source: historic mapping

Style/Form: Greek Revival

Architect/Builder:

Exterior Material:

Foundation: stone

Wall/Trim: clapboard

Roof: asphalt shingle

Outbuildings/Secondary Structures: None

Major Alterations (with dates): complete exterior renovations (dates unknown. See architectural description)

Condition: Good

Moved: no | X | yes | | **Date**

Acreage: 1.18 Acres

Setting: residential

Recorded by: Richard M. Casella / Wm. Coutu

Organization: Historic Documentation Co., Inc.

Date: 2008

INVENTORY FORM B CONTINUATION SHEET

[DARTMOUTH] [557 Elm Street]

MASSACHUSETTS HISTORICAL COMMISSION
220 MORRISSEY BOULEVARD, BOSTON, MASSACHUSETTS 02125

Area(s) Form No.

DAR.111

___ Recommended for listing in the National Register of Historic Places.
If checked, you must attach a completed National Register Criteria Statement form.

ARCHITECTURAL DESCRIPTION:

Earlier form missing in Dartmouth. This 1-1/2 story front gable side hall Greek Revival house has recently undergone complete exterior renovation: new insulated windows with exterior and interior grilles some in original openings, some in altered openings; reconstructed front entrance; ell added with glass greenhouse. Compare present photos to those on previous form.

HISTORICAL INFORMATION:

1856 Map: House shown with name "C.S. Gifford"

1871 Map: House not shown

1895 Map: House shown with name "E. Sturtevant"

Tax Card, 1st Entry: 1845, Mrs. E. B. Sturtevant, Book 12 Page 40

BIBLIOGRAPHY and/or REFERENCES

Walling, Henry F., *Map of the Town of Dartmouth, Bristol County, Mass.* 1856.

Beers, F. W., *Atlas of Bristol County, Massachusetts.* New York: F.W. Beers & Co., 1871

Walling, Henry F., *Map of Bristol County, Massachusetts.* 1895.

Town of Dartmouth, Massachusetts, Tax Assessor's Record Cards.

INVENTORY FORM B CONTINUATION SHEET

[DARTMOUTH] [557 Elm Street]

MASSACHUSETTS HISTORICAL COMMISSION
220 MORRISSEY BOULEVARD, BOSTON, MASSACHUSETTS 02125

Area(s) Form No.

DAR.111

LOCATION MAPPING

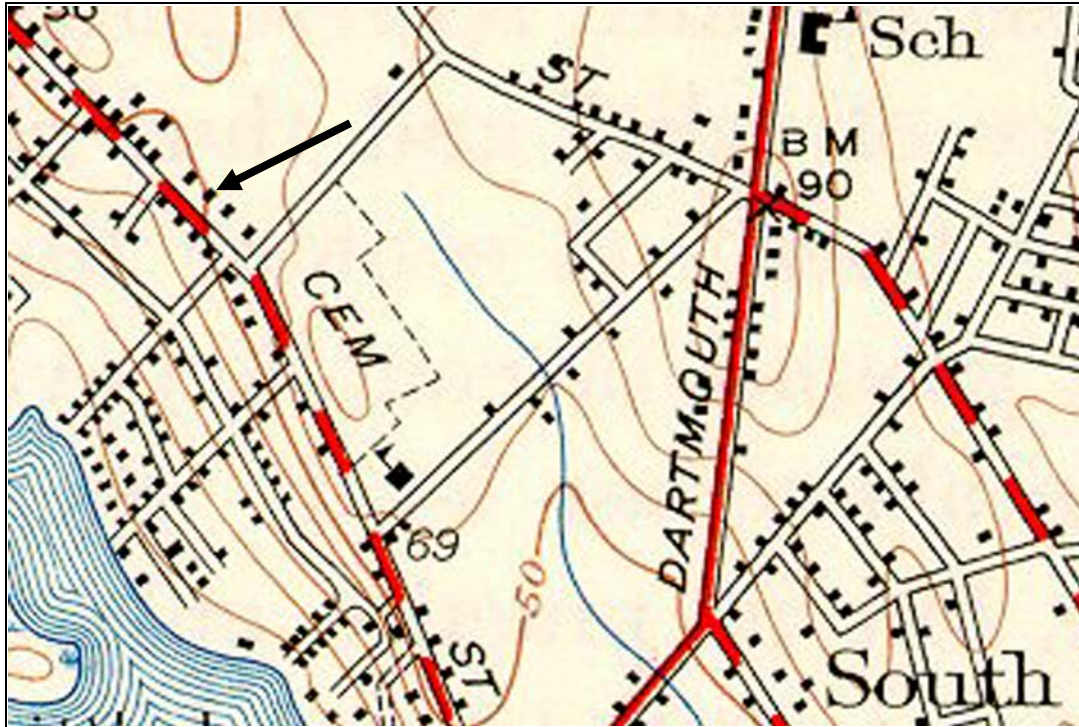

USGS Topographic Map New Bedford South Quadrangle 1941, Revised 1948

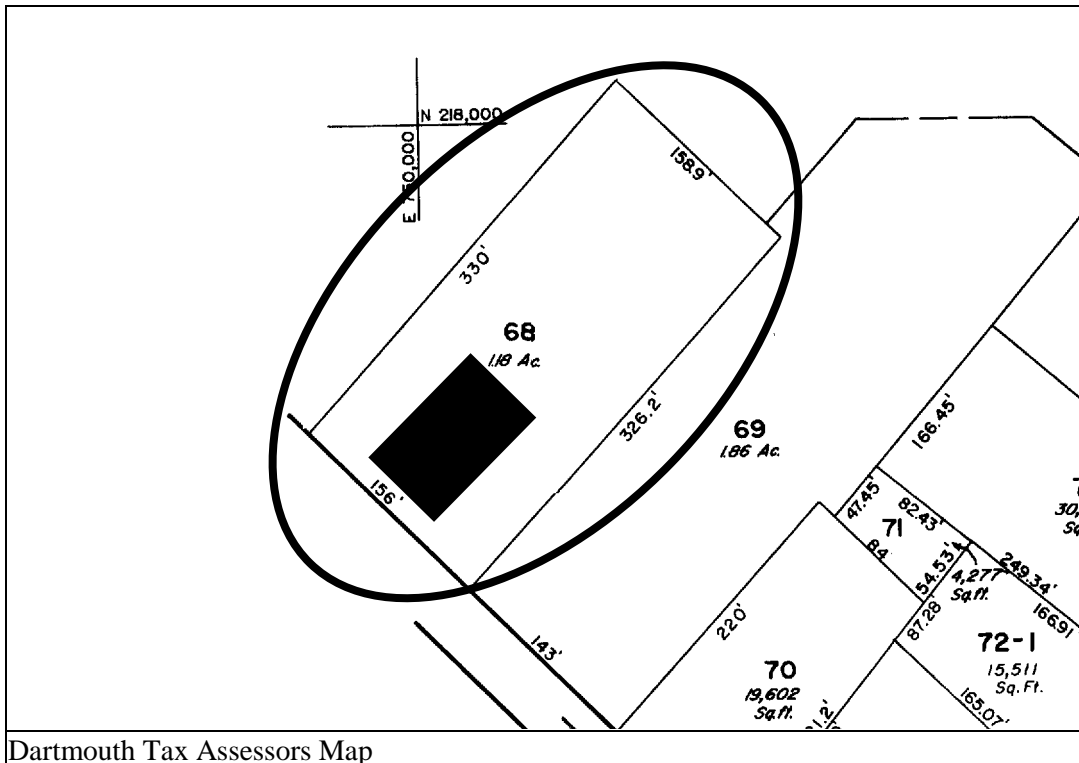

Dartmouth Tax Assessors Map

INVENTORY FORM B CONTINUATION SHEET

[DARTMOUTH] [557 Elm Street]

MASSACHUSETTS HISTORICAL COMMISSION
220 MORRISSEY BOULEVARD, BOSTON, MASSACHUSETTS 02125

Area(s) Form No.

	DAR.111
--	---------

ARCHIVAL PHOTOGRAPHIC PRINT(S) ATTACHED:

