

# FORM B – BUILDING

Assessor's Number    USGS Quad    Area(s)    Form Number

MASSACHUSETTS HISTORICAL COMMISSION  
MASSACHUSETTS ARCHIVES BUILDING  
220 MORRISSEY BOULEVARD  
BOSTON, MASSACHUSETTS 02125

118-26	New Bedford South		DAR.124
--------	-------------------------	--	---------

**Town:** Dartmouth

**Place:** Padanaram

**Address:** 10 Franklin Street

**Historic Name:** Mrs. S. Johnson (1856)

**Uses: Present:** Single family home

**Original:** Same

**Date of Construction:** Tax Database: 1850

**Source:** Historic mapping

**Style/Form:** Greek Revival [with Italianate details]

**Architect/Builder:**

**Exterior Material:**

Foundation: stone

Wall/Trim: shingles

Roof: asphalt shingle

**Outbuildings/Secondary Structures:** None

**Major Alterations** (*with dates*):

see architectural description

**Condition:** Good

**Moved:** no | X | yes | | **Date**

**Acreage:** 0.35

**Setting:** Residential

## Photograph



## Topographic or Assessor's Map

see continuation sheet

**Recorded by:** Richard M. Casella / Wm. Coutu

**Organization:** Historic Documentation Co., Inc.

**Date:** 2008

# INVENTORY FORM B CONTINUATION SHEET

[DARTMOUTH] [10 Franklin Street]

MASSACHUSETTS HISTORICAL COMMISSION  
220 MORRISSEY BOULEVARD, BOSTON, MASSACHUSETTS 02125

Area(s) Form No.

DAR.124

Recommended for listing in the National Register of Historic Places.  
*If checked, you must attach a completed National Register Criteria Statement form.*

## ARCHITECTURAL DESCRIPTION:

This structure is a very handsome example of the Greek Revival mode in Dartmouth. The gable end is front facing and the front entrance is located at this façade on the right side. This doorway is framed by pilaster and sidelights. A front entrance porch is located here as well, and may be original to the structure. It is supported by paneled columns and the cornice of the porch roof is accented by dentils. The structure is 2 ½ stories in height and pilasters are at the corners. They are paneled. The cornice is extended and accented by brackets. Cornice ends in return. A square cupola is at roof, with panels, windows and an extended cornice with bracketing. Foundation and stairs are granite. [Note: Preceding description transcribed from 1983 survey form]

## HISTORICAL INFORMATION:

**1856 Map:** House shown with name "Mrs. S. Johnson"

**1871 Map:** House not shown

**1895 Map:** House shown with name "E. Manchester"

**Tax Card, 1<sup>st</sup> Entry:** 1894, Edward Manchester, Book 165 Page 280

## BIBLIOGRAPHY and/or REFERENCES

Walling, Henry F., *Map of the Town of Dartmouth, Bristol County, Mass.* 1856.

Beers, F. W., *Atlas of Bristol County, Massachusetts.* New York: F.W. Beers & Co., 1871

Walling, Henry F., *Map of Bristol County, Massachusetts.* 1895.

Town of Dartmouth, Massachusetts, Tax Assessor's Record Cards.

**INVENTORY FORM B CONTINUATION SHEET**

[DARTMOUTH] [10 Franklin Street]

MASSACHUSETTS HISTORICAL COMMISSION  
220 MORRISSEY BOULEVARD, BOSTON, MASSACHUSETTS 02125

Area(s) Form No.

DAR.124

**LOCATION MAPPING**

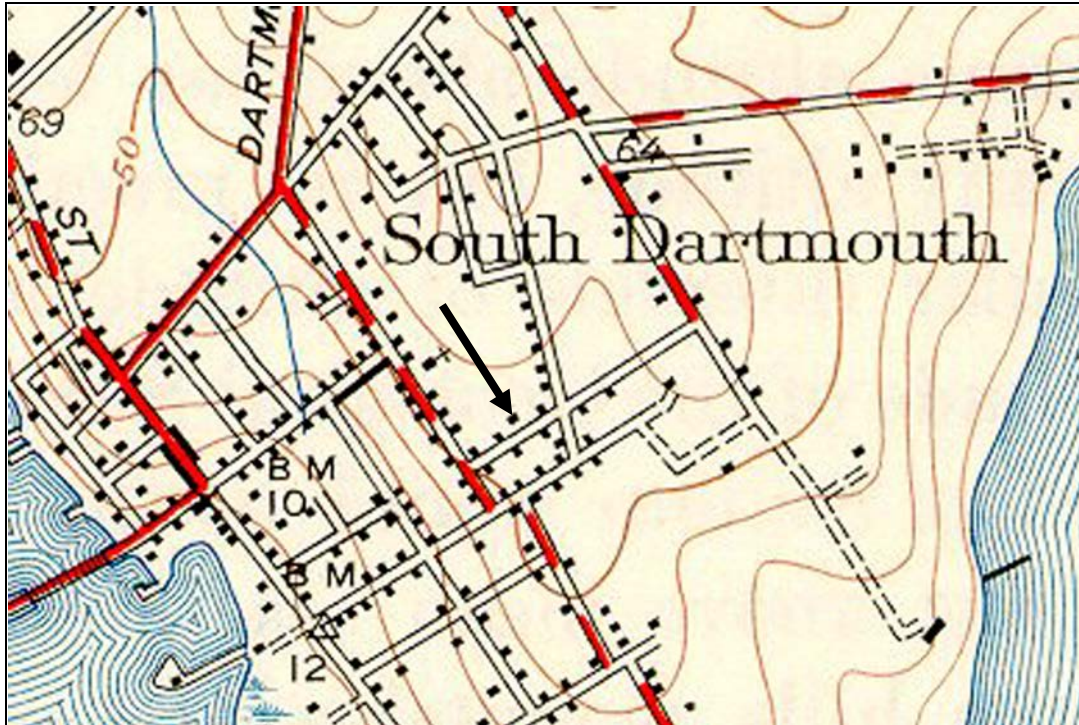

USGS Topographic Map New Bedford South Quadrangle 1941, Revised 1948

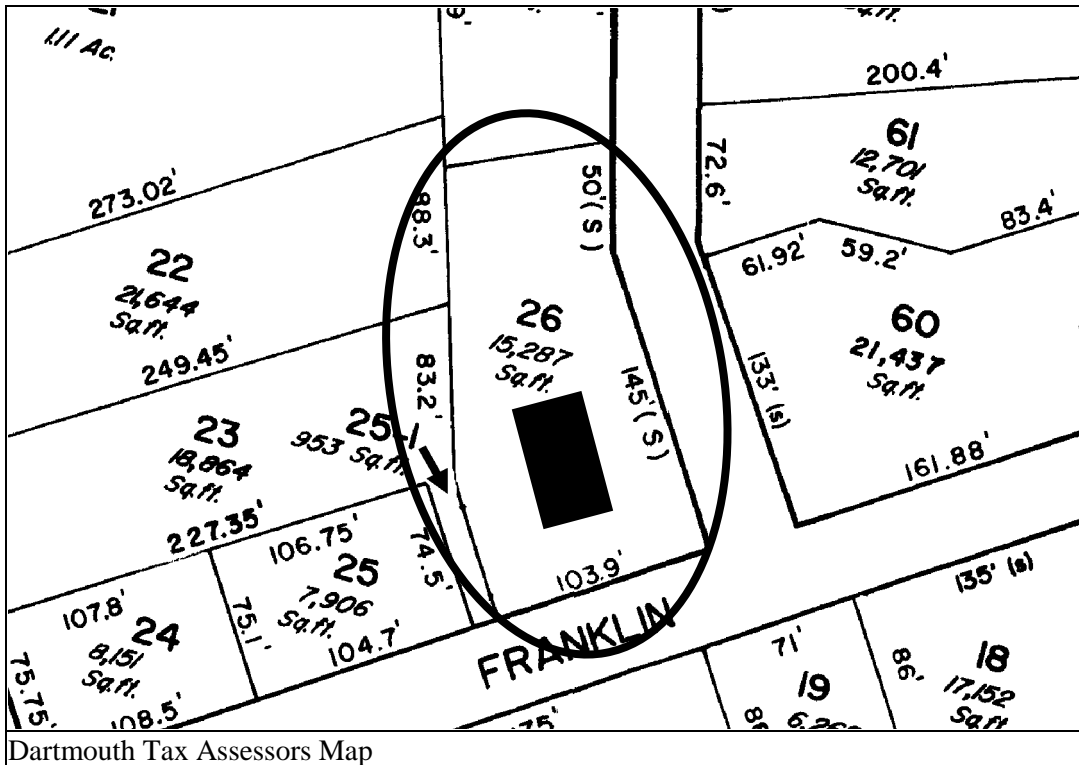

Dartmouth Tax Assessors Map



**INVENTORY FORM B CONTINUATION SHEET**

[DARTMOUTH] [10 Franklin Street]

MASSACHUSETTS HISTORICAL COMMISSION  
220 MORRISSEY BOULEVARD, BOSTON, MASSACHUSETTS 02125

Area(s) Form No.

DAR.124

**ARCHIVAL PHOTOGRAPHIC PRINT(S) ATTACHED:**



**INVENTORY FORM B CONTINUATION SHEET**

[DARTMOUTH] [10 Franklin Street]

MASSACHUSETTS HISTORICAL COMMISSION  
220 MORRISSEY BOULEVARD, BOSTON, MASSACHUSETTS 02125

Area(s) Form No.

	DAR.124
--	---------

**ARCHIVAL PHOTOGRAPHIC PRINT(S) ATTACHED:**

